



**GEARHEADS** Frame size 90mm sq. (3.54 in. sq.)

METAL TYPE & BALL BEARING TYPE

▶ **RATED TORQUE OF GEARHEAD**

MODEL	Synchronous Speed		500	300	200	120	100	60	50	30	20	15	10	9	
	Ratio	Speed	50Hz	3	5	7.5	12.5	15	25	30	50	75	100	150	166.7
<b>L9HK□M</b>	High	kg-cm	60Hz	3.6	6	9	15	18	30	36	60	90	120	180	200
	Low	kg-cm	7.5	12.6	18.8	31.4	37.7	56.6	67.9	100	100	100	100	100	100
<b>L9HK□B</b>	High	N-m	0.74	1.23	1.85	3.08	3.69	5.54	6.65	9.80	9.80	9.80	9.80	9.80	9.80
	Low	N-m	0.24	0.40	0.60	0.99	1.19	1.79	2.15	3.23	4.85	6.47	9.70	9.70	9.70
	High	oz-in	105	174	262	436	523	786	943	1389	1389	1389	1389	1389	1389
	Low	oz-in	34	56	84	141	169	253	304	458	687	917	1375	1375	1375

- \* The normal torque is that the motor and gearhead are directly coupled.
- \* Insert the denominator of reduction ratio in □ of gearhead model name.
- \* Actual rotation speed is 2~15% less than synchronous speed.
- \* ■Color indicates that the rotation of gearhead shaft is in opposite direction as output shaft of motor.

SPEED CONTROL REVERSIBLE MOTORS

**DIMENSIONS**

Unit : mm(inch)

**DECIMAL GEARHEAD**

**L9G10D**

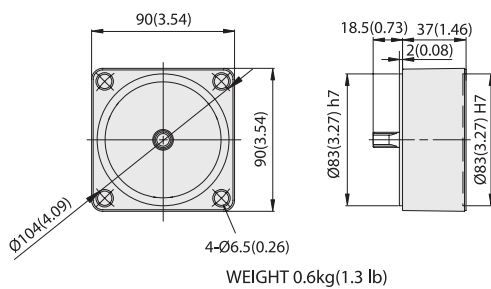

WEIGHT 0.6kg(1.3 lb)



**GEARHEAD**

**L9HK□ M(B)**

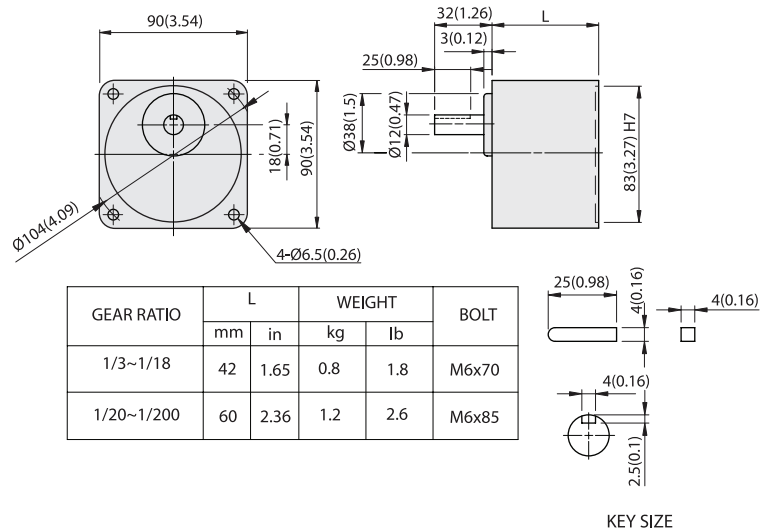

**L9HK□ M(B) + L9R40P□ LT**

